

## Subject: C11020 / C11021 Remote Air Cylinder Breather Kit

**ATTENTION:**

This kit must be used in all applications in which the air cylinder comes in contact with road spray.

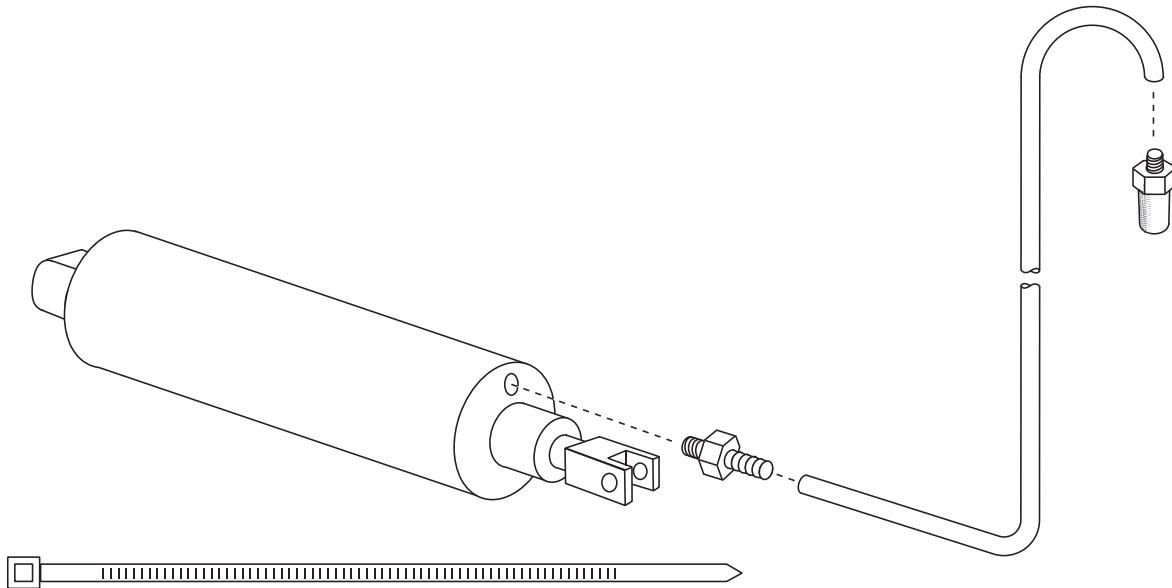

### Remote Air Cylinder Breather Installation Instructions

1. Remove the bronze muffler from the air cylinder.
2. Install the barbed fitting supplied in the breather port of the air cylinder. Do not overtighten.
3. Locate the breather hose supplied, connect one end to the barbed fitting, use a tie strap to secure.
4. Install the bronze muffler removed from the air cylinder earlier into the other end of the breather hose, secure with a tie-strap.
5. Route the muffler end of the breather hose to an area free from road spray.
6. Secure the hose using the tie straps provided.