

- Adjust your air springs with your Android™ 4.3+ or Apple™ iOS™ 10.3+ mobile device
- Three presets for rapid adjustment
- Independent & simultaneous air spring control
- Real time pressure feedback
- Easy installation – can be completed within 1 hour.
 - Preassembled control board & harness.
 - No wires or airlines routed into the cab of the vehicle.
 - No drilling or vehicle modification required.
- Universal fit
 - Bolts onto the frame rail of most truck currently on the market.
 - Integrates into any air spring suspension system.
- No limitations on preset or fill pressures up to 150 psi
- Robust air solenoids, 13 years of validation
- ¼ hp oil-less compressor, with sealed bearings
- Two year warranty

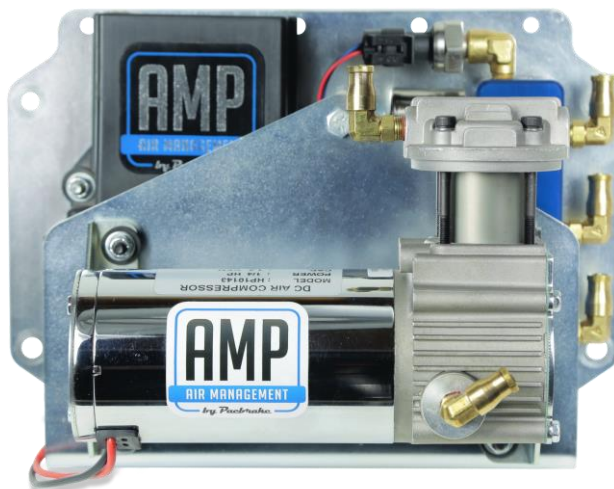

Maximum Air Pressure	10.3 bar (gauge) [150 psig]
Continuous Air Temperature	-40°C to +85°C [-40°F to +248°F]
Ambient Temperature Range	-40°C to +85°C [-40°F to +248°F]
Supply Voltage	12 VDC Switched Ignition
Current Draw (Standby Mode)	35 mA
Current Draw (Bluetooth Connected)	80 mA
Current Draw (Solenoids)	1.5A ea.
Mobile Device Operating System	Android 4.3+ (Jellybean) or Apple™ iOS™ 10.3+
Pressure Feedback Units	PSI
Pressure Feedback Accuracy	±1
Ingress Protection (Weatherproof)	IP67 Controller and Connectors
Maximum Frame Size* (WxH)	4.750 x 9.125" [120 x 232 mm]

*Frame size refers to the cross sectional dimensions of the frame. At the time of this release, 4.750" x 9.125" is sufficient for any pickup truck currently on the market.

All information contained in this document is for reference only, subject to change without notice.

Control Board & Compressor

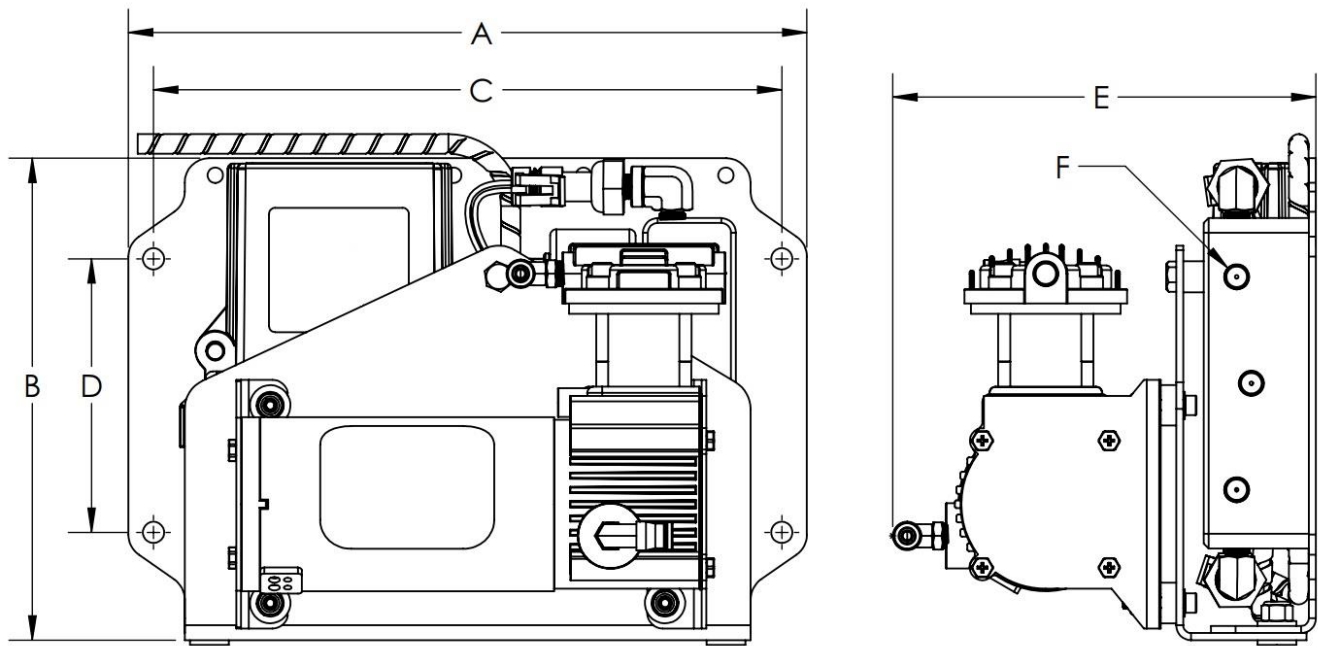

A	B	C	D	E	F	WEIGHT	HARNESS LENGTH
277 mm 10.9 in	197 mm 7.8 in	257 mm 10.1 in	112 mm 4.4 in	173 mm 6.8"	1/8" NPT	7.7 kg 16.9 lb	9.1m 30 ft

Frame Bracket

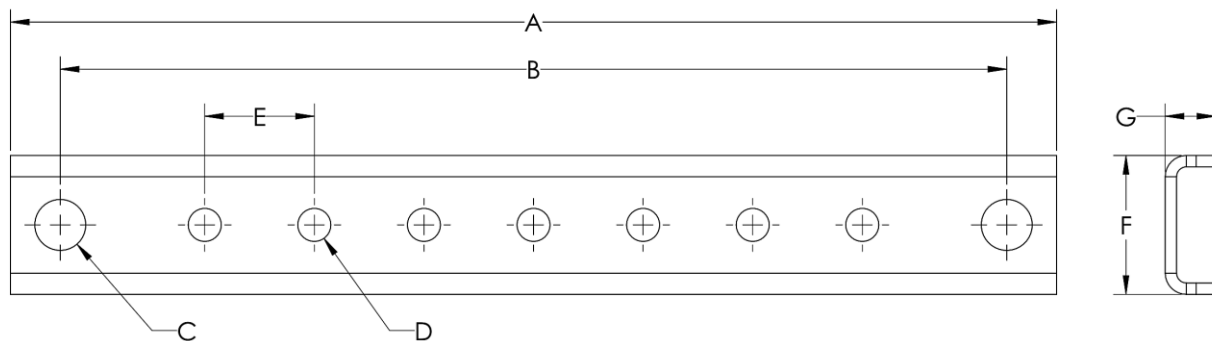

A	B	C	D	E	F	G
266 mm 10.5 in	241 mm 9.5 in	13 mm .512 in	8.4 mm .332 in	28 mm 1.1 in	35.4 mm 1.4 in	13 mm .508 in

All information contained in this document is for reference only, subject to change without notice.

Compressor

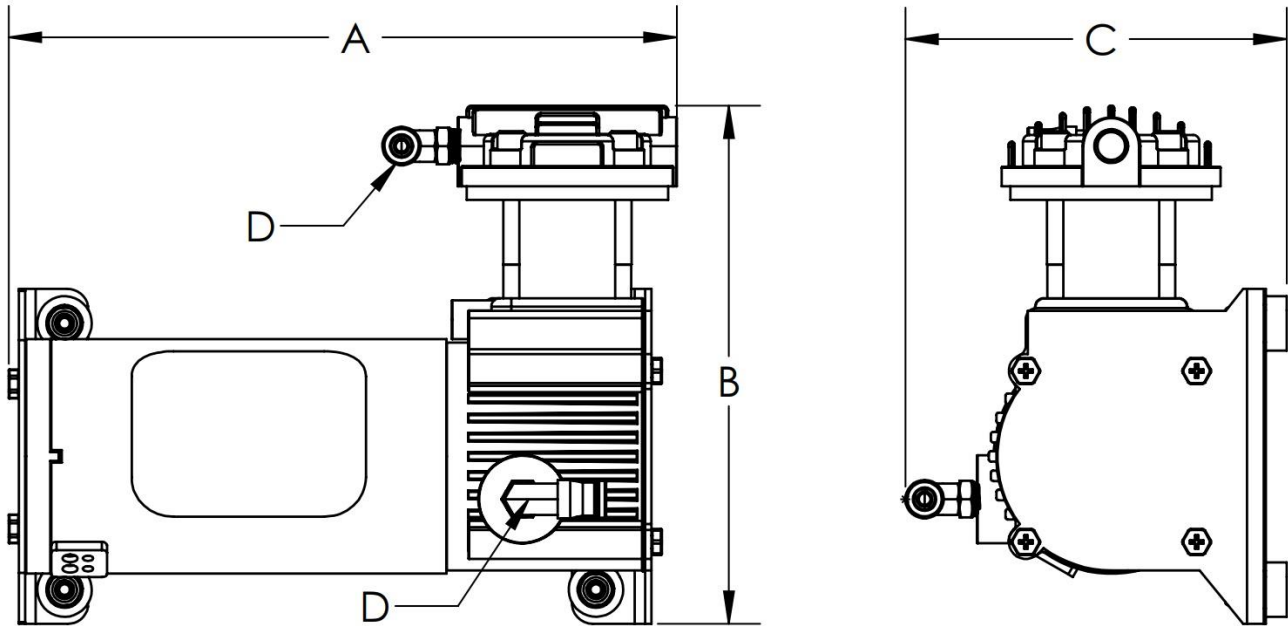

A	B	C	D
221 mm 8.7 in	158 mm 6.2 in	118 mm 4.6 in	¼" Airline Fitting

Weight	5.5 lbs [2.49 kg]
Size	8.7" x 4.6" x 6.2" [221 mm x 118 mm x 158 mm]
Ambient Temperature Range	-40°C to +70°C [-40°F to +158°F]
Max Duty Cycle	33% (20 Minutes @ 100 psi)
Ingress Protection	IP55 w/remote intake
Rated Flow	1.1 SCFM
Max Working Pressure	150 psi [1034 kPa]
Max Restart Pressure	135 psi [931 kPa]
Motor Type	Permanent magnet DC
Operating Voltage	12 VDC ± 15%
Maximum Current Draw	17 A
Nominal Power	¼ HP
Nominal Speed	3000 RPM

All information contained in this document is for reference only, subject to change without notice.

U-Bolt



A	B	C	Grade
241 mm 9.5 in	140 mm 5.5 in	3/8"-16 UNC	SAE No. 2 Equivalent

Legal

- Apple, the Apple logo, iPhone, and iPod touch are trademarks of Apple Inc., registered in the U.S. and other countries. App Store is a service mark of Apple Inc., registered in the U.S. and other countries.
- Google Play and the Google Play logo are trademarks of Google LLC
- Android is a trademark of Google LLC
- The Android robot is reproduced or modified from work created and shared by Google and used according to terms described in the Creative Commons 3.0 Attribution License.

All information contained in this document is for reference only, subject to change without notice.